

схема сборки и установки / assembling & connection diagram

Model No.: 6315-8D Size: $\Phi 800 \times H 680 \text{mm}$ E14*18

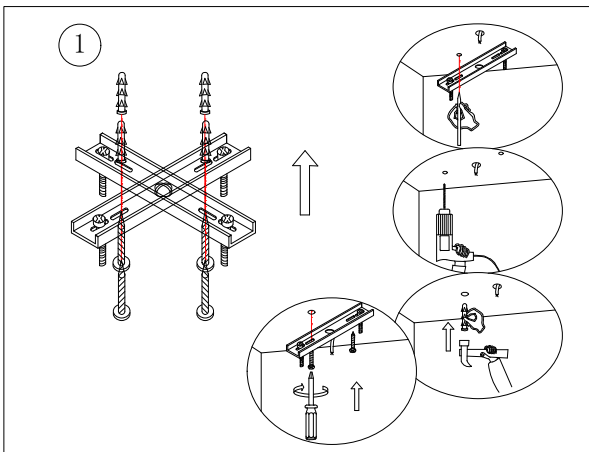

1
Take out the cross hanging plate, and fix the cross hanging plate on the outlet position of the ceiling (it is recommended to use tapping expansion screws)

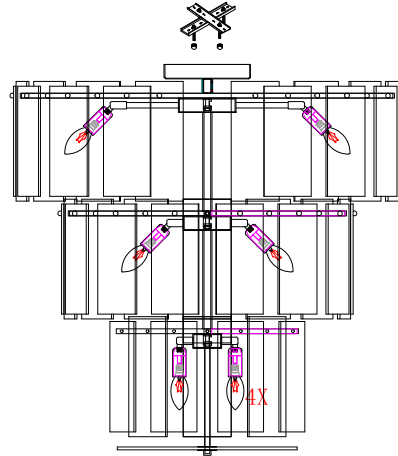
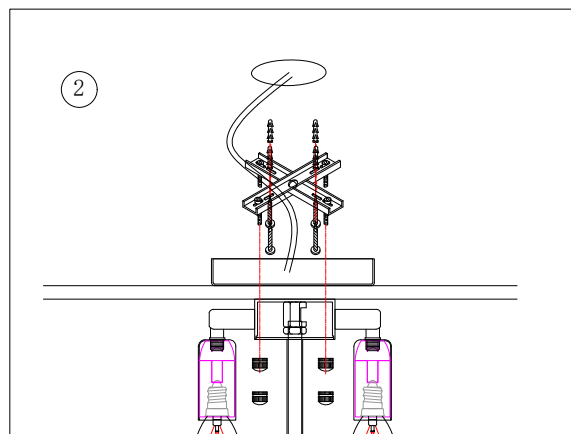

2
Assemble the lamp body and connect the power cord, fix the ceiling plate on the hanging board with sprig nuts/install the light source and try to light it (if hoisting is required, remove the ceiling plate and add a hanging chain in the middle)

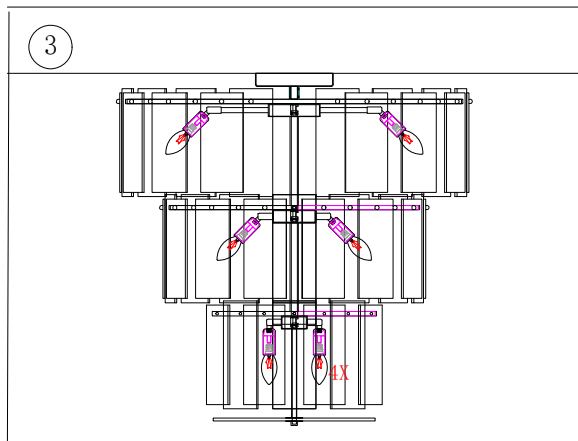

3
install the glass lampshade

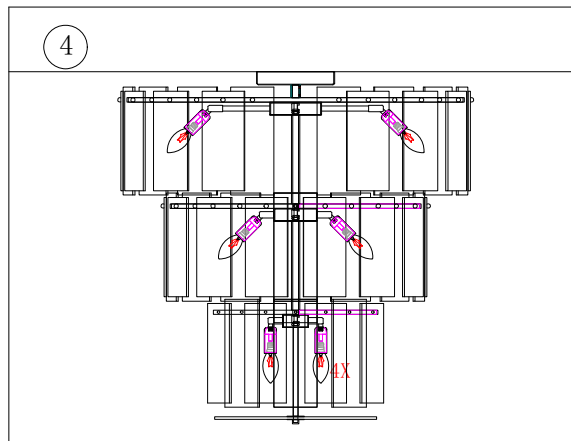

4
install the glass and test the light